

# For Lease

## South County Executive Building

Office Suites 600± Sq. Ft. to 4,500± Sq. Ft.



5% COMMISSION TO  
PROCURING AGENT

**4121 Union Road  
St. Louis, MO 63129**

Lease Rate:

**\$17.50 Per Sq. Ft., Full Service**

Contact: A. William Aschinger

- Across from South County Mall
- Mixed Use Retail/Office Building
- Multiple Suites Available
- Elevator Serviced
- Covered Executive Parking
- Easy Access to I-55 and I-270
- Great for Professional Office or Medical Center



Office Industrial Retail Institutional Investment Management



Commercial Real Estate  
1401 S. Brentwood Blvd.  
Suite 650  
St. Louis, MO 63144  
[www.hillikercorp.com](http://www.hillikercorp.com)

**314 781 0001**

 Individual Membership in the Society  
of Industrial and Office Realtors

**4121 Union Road  
St. Louis, MO 63129**

6/1/2017

**SECOND FLOOR**



**STREET LEVEL PARKING LOT**

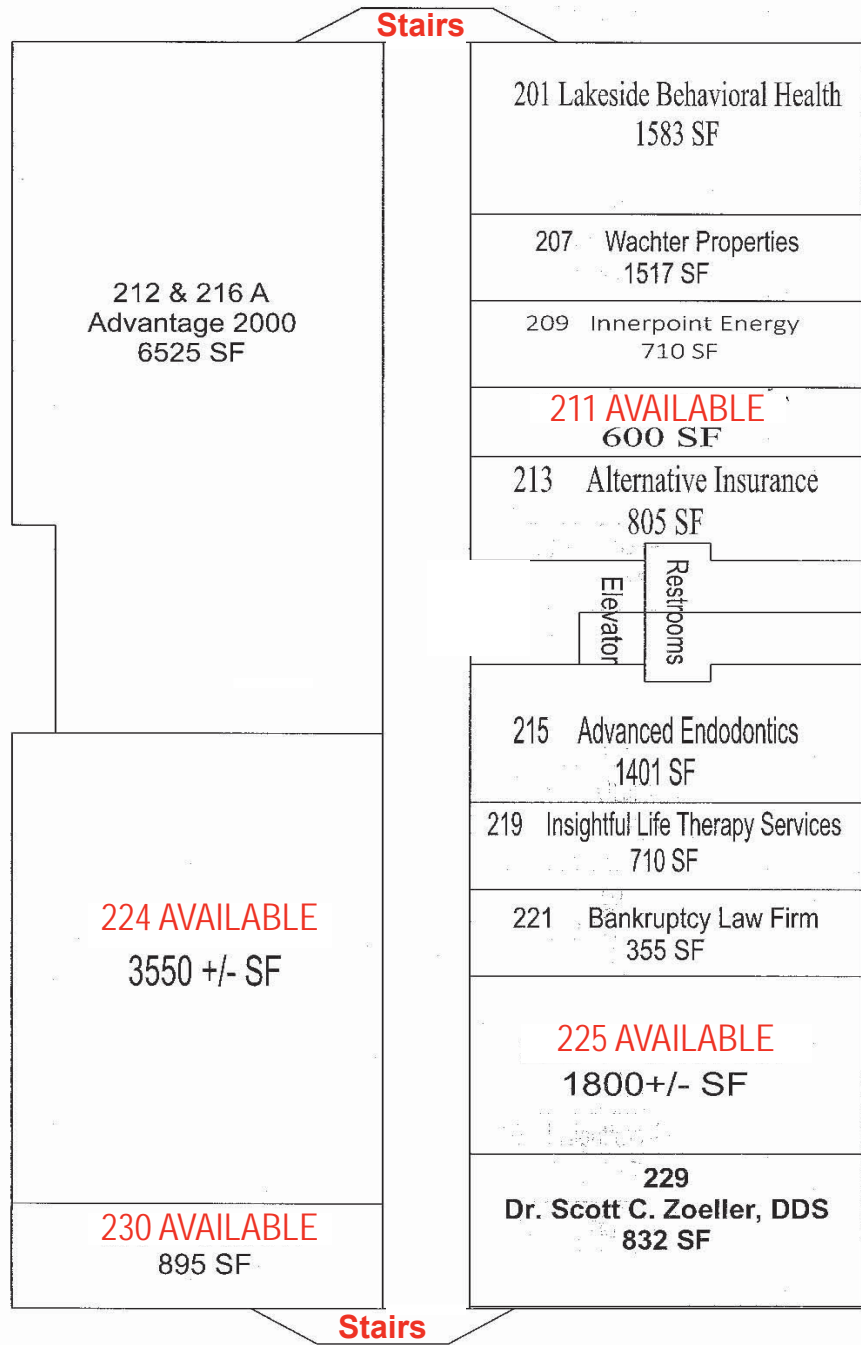

**Office Industrial Retail Institutional Investment Management**



Commercial Real Estate  
1401 S. Brentwood Blvd.  
Suite 650  
St. Louis, MO 63144  
www.hillikercorp.com

**314 781 0001**

**SIOR** Individual Membership in the Society  
of Industrial and Office Realtors