

# For Lease

## 2,300± Sq. Ft. Retail Space



**9800 Manchester Rd.  
Rock Hill, MO 63119**

**Lease Rate:  
\$16.00/ Sq.Ft., NNN**  
**Contact: Jon Wilsonholme**

- 2,300± Sq. Ft. Space Available
- Former Penn Station
- Signalized Intersection with Monument Signage
- Drive-Up ATM on Site
- Ample Parking
- 25,000± Vehicles per Day on Manchester

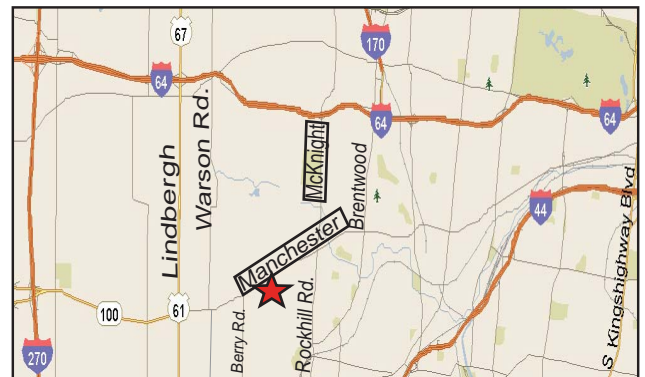

■ Demographics	1 Mile	3 Miles	5 Miles
*Population	10,202	86,145	257,661
*Households	4,177	36,267	111,348
*Avg. HH Income	\$107,017	\$112,238	\$103,056

Office Industrial Retail Institutional Investment Management



Commercial Real Estate  
1401 S. Brentwood Blvd.  
Suite 650  
St. Louis, MO 63144  
www.hillikercorp.com

**314 781 0001**

 Individual Membership in the Society  
of Industrial and Office Realtors

9800 Manchester Rd.

Rock Hill, MO 63119

Contact: Jon Wilsonholme

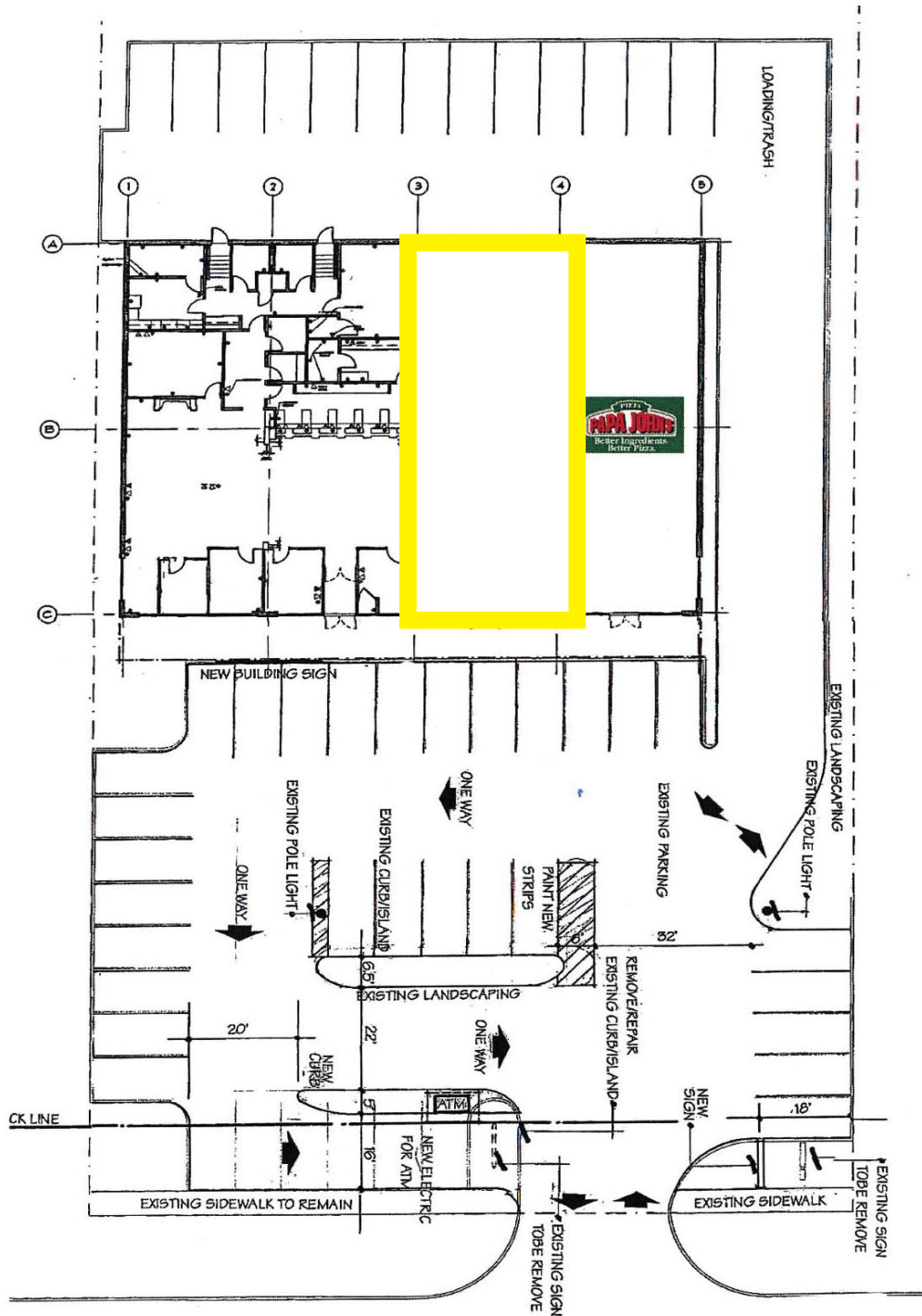

Office Industrial Retail Institutional Investment Management



Commercial Real Estate  
 1401 S. Brentwood Blvd.  
 Suite 650  
 St. Louis, MO 63144  
 www.hillikercorp.com

314 781 0001

 Individual Membership in the Society  
 of Industrial and Office Realtors